

tc core 112: Quiz 4

There are two sides to this quiz. You can use a calculator and a five-sided 3×5" notecard with anything written or typed on it.

1. [4] (Lang pg 93-97) Identify the name of the base and it's variation that is used in the directions below.

Octopus by Lee Armstrong

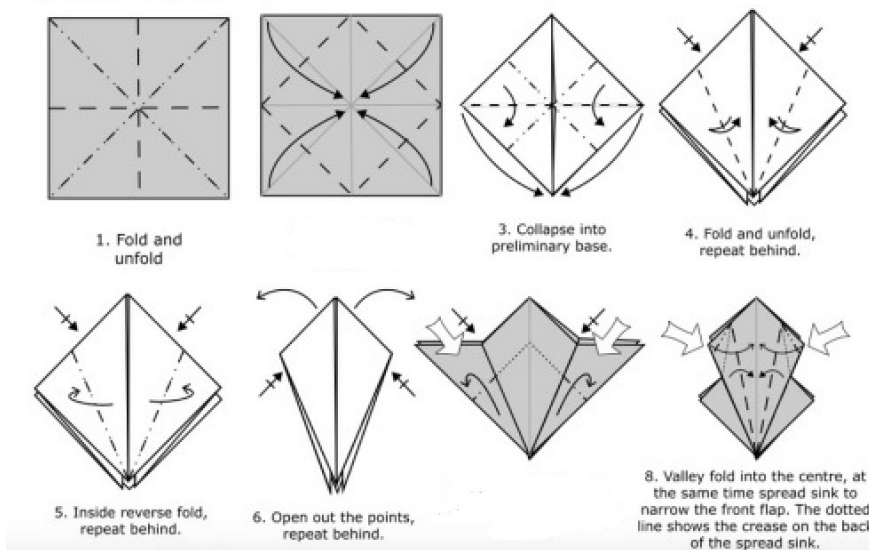

2. (Activity3 #4) Consider a transversal line t making eight angles as it crosses lines m and p . For each of the following statements, if they are *always* true, write true and provide brief justification. If the statement is not always true, provide an example when the statement is false.

(a) [3] Corresponding angles have the same measure.

(b) [3] Vertical angles have the same measure.

3. [2] (Lang pg 97-100) Describe a scenario when an origami designer may want to use the Yoshizawa split.

4. [3] (Class Discussion 2/21) Describe a scenario in which you may choose to change a grading option from standard (S) to non-standard (NS).

5. [5] (Class Folding 2/19) Fold a stretched bird base. Note that the bird base directions are below if needed, but the stretched variation does not have directions (at least found in Lang's text!)

