

Advanced Training Program
On Economics and BA Research and Publishing
University of Washington, Seattle, August 13-31, 2007

Dorm Information

All participants, unless stated otherwise, will stay in Terry Hall.

Terry Hall



Terry Hall is conveniently located on Campus Parkway, just two blocks west of the main University of Washington (UW) Campus. It is within walking distance to shopping and recreational facilities in the University District, public transportation, the UW Medical Center, and south campus classrooms. The dorm rooms are designed to accommodate one or two guests, with one set of bathrooms per floor. TV lounges are available on every floor. Moreover, many of the rooms offer striking views of downtown Seattle and Portage Bay. Located on the main floor is Eleven 01, a beautiful new dining facility which features a variety of dining concepts and a convenience store/espresso bar.

Location

Terry Hall is located on:

1101 NE Campus Pkwy.
Seattle, WA 98105

Directions to Terry Hall from Campus Parkway and Brooklyn: Head west (right) down Campus Parkway crossing Brooklyn Avenue. Terry Hall will be the second of the two buildings to your left. The building next to it is Lander Hall.

Check in and check out information

The front desk is located at the Terry Hall main entrance.

Office hours are 7am-11pm.

Check in: 2:00 p.m.

Check out: 11:00 a.m.

Room Diagram

Diagram of a typical room (room size may vary):

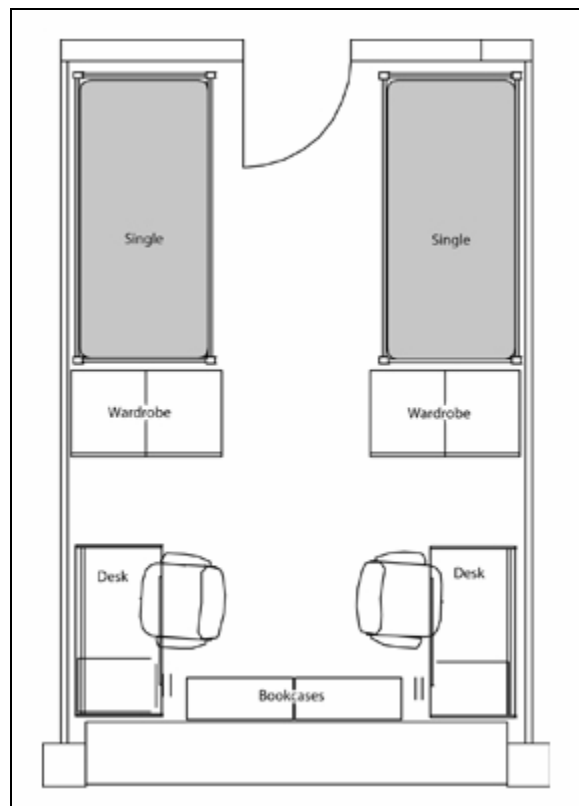

Amenities

- Ethernet access
- Computer lab with Ethernet access (located on the Terry Hall side of the community)
- Fitness center with lifecycles, stairmasters, a rowing machine, treadmills, and aerobic exercise space

- Activities center with a photography darkroom, a crafts room, saunas, and a game room with video games, pool, foosball, air hockey, and table-tennis
- Study rooms
- Large-screen TV room
- Covered basketball courts
- Eleven 01, located on the Terry Hall side of the community, the newest campus restaurant featuring three dining concepts and an espresso bar/convenience store
- Carpeting in each room
- Loftable and movable furniture in each room
- A convenience store which accepts dining cards (located on the Terry Hall side of the community)

Building access

You will be provided with a dining card at the time of check-in. This card is programmed to work as an entry card allowing access into the residence hall. In addition, it provides access to the dining facilities in Terry, McCarty and McMahan Halls during their operating hours. The residential wings of these halls are accessible only to the residents of the building.

Computing Facilities

If you bring a computer to campus, direct connection to the UW systems, email and the Internet is available by Ethernet connection in your residence hall room. Connecting cables may be purchased at on-campus convenience stores.

Dining Services

Method of payment

You may use either cash or your dining card at on campus dining facilities. When making a purchase, simply present your dining card and the amount of your purchase will automatically be deducted from your account.

Dining Facilities in Terry Hall

- Eleven 01.

Eleven 01 in Terry Hall is a fun and modern new restaurant on UW campus. There, you can enjoy WiFi access in your private seating by a window or dine with friends while watching a big-screen television. A rotating selection of hot entrées, combo meals, fresh gourmet sandwiches, tossed-to-order salads, fresh pasta and hearty soups will be available during the meal periods listed below:

Eleven 01 Dining Services Operation Hours		
Breakfast	7:00AM - 9:00AM	MON-SUN

Lunch	11:30AM - 1:30PM	MON-SUN
Dinner	5:30PM - 7:00PM	MON-SUN

- 2 Convenient

2 Convenient is located in Eleven 01 at Terry Hall. It is a convenience store and espresso bar. If you are in a hurry, you will appreciate the wide selection of grab-n-go salads, sandwiches, vegan and vegetarian items, and all your favorite snacks. The espresso bar offers Tully's soft-serve ice cream and thick, rich shakes.

2 Convenient Services Operation Hours	
7:00 AM- 10:00PM	MON-SUN

What to bring to the dorm

Listed below are some items you might bring along to make your stay on campus more comfortable. Seattle weather is generally mild, with summer temperatures averaging around 20-30°C. Heat waves occur occasionally and most campus buildings, including the residence halls, are not air-conditioned. However, also be prepared for cooler evenings and some rain showers.

- Radio/alarm
- Shower slippers
- Lounge wear (appropriate for a common living area)
- Umbrella and/or raincoat

The University of Washington is a pedestrian campus; bring comfortable walking shoes.

Laundry

Community laundry rooms with washers and dryers are located in every building. Instructions for using the washers and dryers are posted. Weekends are usually the busiest times in the laundry rooms, so plan accordingly.

Your dining card contains two debit accounts: your dining funds and a laundry account, which is used for laundry services. You will be able to deposit funds into your accounts at the front desk. However, bear in mind that the funds that you put into your laundry account is non-refundable so it is highly recommended that you only put in the amount that is required. Residence hall laundry machines do not accept cash.

Laundry Costs	
Cycle	Cost per load
Wash	\$1.00
Dry	\$1.00

Smoking Policy

University residence halls and campus facilities offer a smoke-free environment. Smoking is prohibited by law in all areas, including lounges, laundry rooms, food service areas, and sleeping and meeting rooms.

Lost cards and key

Your dining card is as good as cash and is an entry key to your building. If you lose your card, there is nothing to prevent others from using it, so it is important to report your lost card by immediately notifying your residence hall desk. There is a \$10 non-refundable fee for the replacement of dining cards.

The room key issued to each resident is the property of the University and is issued to a particular resident for his or her exclusive use. Students are not permitted to lend or give their room keys to anyone or any University group. Students are not permitted to put their own locks or alarms on any residence hall doors. Lost or misplaced keys should also be reported immediately to the residence hall desk. You will be charged a nonrefundable fee of \$85 for a replacement key.

Lockouts

If you are locked out of your room, you may temporarily check out keys by following the procedures listed below, developed to protect you from the possibility of unauthorized entry into your room:

- If you are locked out of your room during desk hours, go to your residence hall's desk. You will be asked to provide photo identification, a signature and/or identifying information, to be verified with information on file.
- If you are locked out and cannot go to the desk yourself, another resident may borrow a key on your behalf. An authorization form may be obtained from the hall desk. You will be asked to provide your name, student number, permanent address, room number, date, signature and the name and room number of the person borrowing the key. The residence hall desk staff will compare the signature on your note to your signature on your key card to verify you are the one making the request.
- The lockout key must be returned to the desk within 24 hours. If you do not return the lockout key on the same day, a staff member will follow up with you. Failure to return the key by the specified time may result in a lock change at your expense.
- If you are locked out after desk hours, call 206-934-DUTY.

This key checkout procedure is the best protection against theft and intrusion into the residence halls. No exceptions to this procedure can be made.